



HIGH-EFFICIENCY TOILET WITH DUAL FLUSH

Assembly and Installation, Care and Use Instructions
IMPORTANT, RETAIN FOR FUTURE REFERENCE: READ CAREFULLY

Check to make sure you have the following parts indicated below:



(A) Toilet Tank Cover



(B) Toilet Seat



(C) Braided Hose



(D) Toilet Bowl



(E) Floor Bolts (2)



(F) Wax Ring



(G) Bolt Caps (2)

Tools/Parts that may be needed (not included):

Adjustable Wrench
Screwdriver

Carpenter's Level
Measuring Tape

Hacksaw
Sealant

Closet Flange
Angle Supply

Need Help?

Please call our toll-free Customer service line at **1-866-789-2273 (ENGLISH)**
 for additional assistance or service.
 Call Monday through Friday 8am-8pm, Saturday 9am-6pm (**EASTERN TIME**)

Model: C22133C

Installation Procedure

Shut off main water supply before installation.

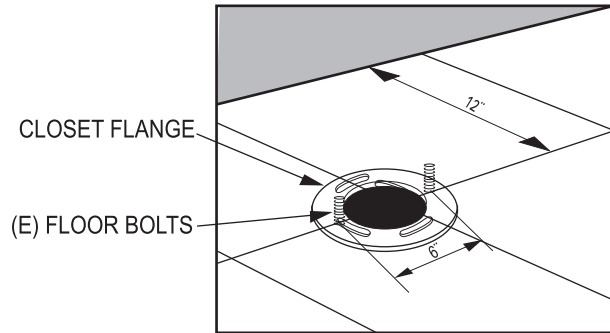

* Closet flange is not included in the package. It can be found at your local hardware store.

- 2** INSTALL FLOOR BOLTS:
Install floor bolts in the channel of the closet flange, turn 90°, and slide into place 6 in/15.2 cm apart and parallel to wall.

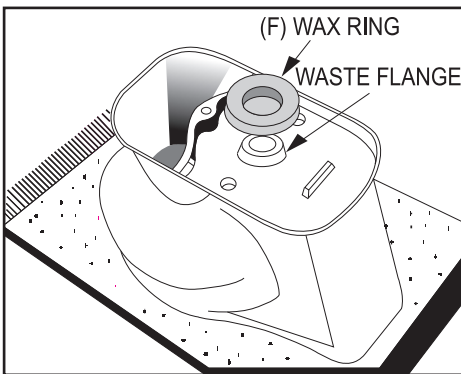

- 1** INSTALL WAX RING:
Invert toilet on the floor (cushion to prevent damage).
Install wax ring evenly around the waste flange with the tapered end of ring facing the toilet.

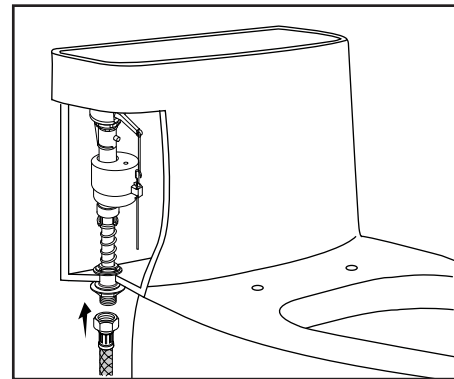

- 3** Connect braided supply line to water inlet on the toilet tank.

MAINTENANCE

Wipe the outside of the toilet with a non abrasive cleaner and a soft towel. Make sure the complete surface is clean and dry.

NOTE: IMPROPER CARE MAY VOID THE WARRANTY



4 INSTALL TOILET ON FLANGE

- i. Remove waste covering and install toilet on closet flange so bolts project through mounting holes.
- ii. Loosely install retainer washers and nuts. (Larger diameter side of washers must face up!)

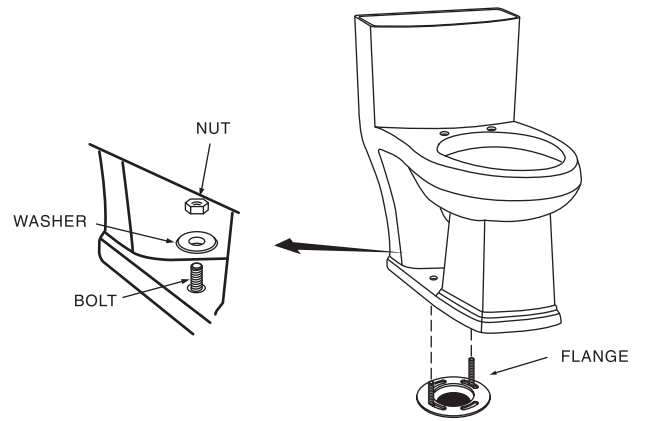

5 INSTALL TOILET

- i. Position toilet squarely to wall and with a rocking motion, press bowl down fully on wax ring and flange. Alternately tighten nuts until toilet is firmly seated on floor.
CAUTION: DO NOT OVERTIGHTEN NUTS OR BASE MAY BE DAMAGED!
- ii. Install caps on washers. (If needed, cut bolt height to size before installing caps.) Place a bead of sealant around base. Remove excess sealant.

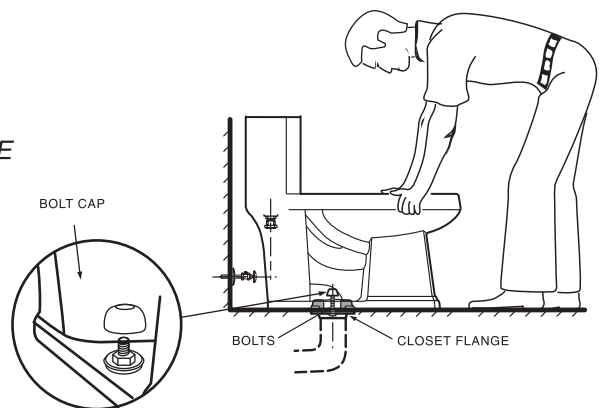

6 INSTALL WATER SUPPLY:

Install braided hose and angle supply (not included in the package) to the water supply pipe and the threads of the tank fill valve. **DO NOT USE TEFLON TAPE OR PIPE DOPE.** This could result in over-tightening and breakage.

- * **Connecting the Water Supply Line:**
CAUTION: DO NOT USE CONE WASHER OR O-RING WITH PLASTIC SUPPLY LINE.

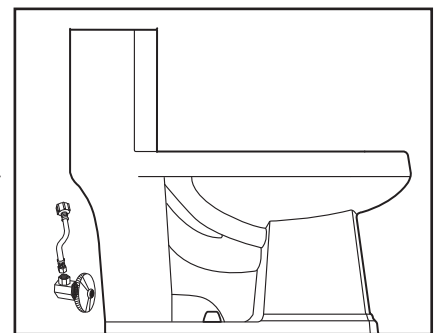

MAINTENANCE

Wipe the outside of the toilet with a non abrasive cleaner and a soft towel. Make sure the complete surface is clean and dry.

NOTE: IMPROPER CARE MAY VOID THE WARRANTY



CAUTION: Overtightening of LOCK NUT or COUPLING NUT could result in breakage and potential flooding

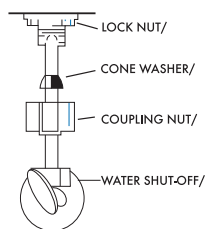

These parts must be used as illustrated to ensure water-tight connection. Use of existing coupling nut may result in water leakage. Water supply tube or pipe must extend at least 1/2" inside threaded shank of valve (does not apply to flanged tubing).

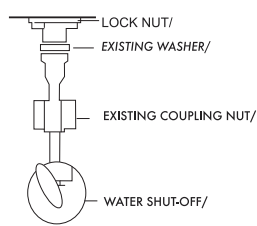
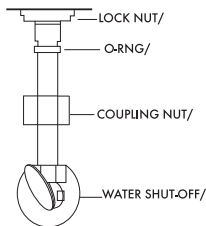

Use existing coupling nut and washer.

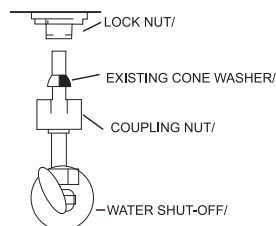

Use existing spiral cone washer. Cone washer may not seal completely on spiral type supply line.

FOR GALVANIZED PIPE ONLY. You must break out the center of the COUPLING NUT by striking it lightly with a hammer or blunt end of screwdriver handle. Discard center portion. Use O-RING instead of cone washer.

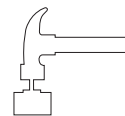

7 ADJUSTMENTS

- Insert refill tube into overflow tube.
- Flush tank and check that tank fills and shuts off at marked water line. Adjust water level adjustment rod on the fill valve if necessary. (Clockwise to raise level; counterclockwise to lower level.)
- Carefully position tank cover on tank.
- Check the right direction between the push button and the flush valve. The large push button (full flush) should be directed to the "●" button on the flush valve, and the small one (partial flush) to the "◐" button.

Note: The flush rate has been preset correctly. No need for the consumers to adjust again.

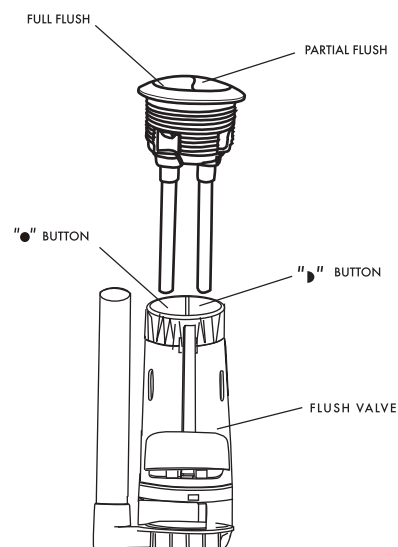
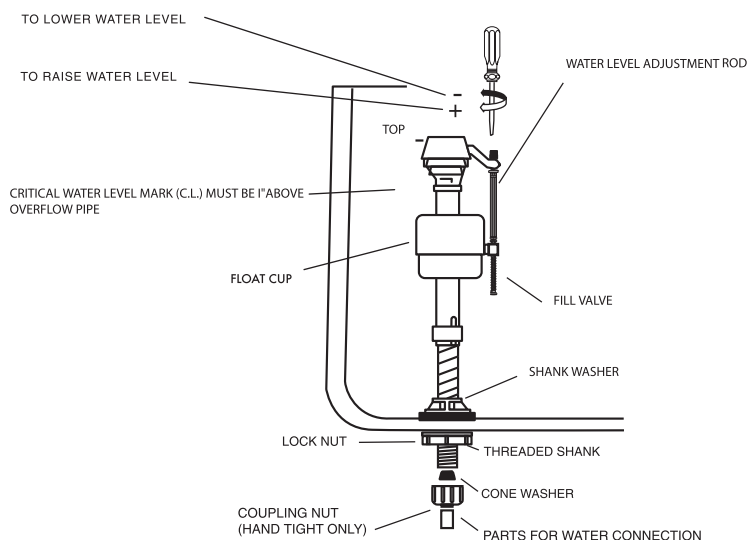

Need Help? Please call our toll-free Customer service line at **1-866-789-2273 (ENGLISH)** for additional assistance or service. Call Monday through Friday 8am-8pm, Saturday 9am-6pm (**EASTERN TIME**)



8 INSTALL TOILET SEAT

i. Please check the hinge set package for the seat installation instruction.

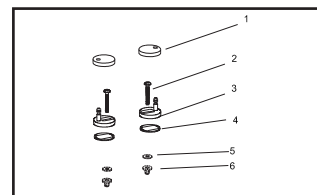

ii. Insert the hinge into the installation hole on the toilet. Loosely tighten the nuts.

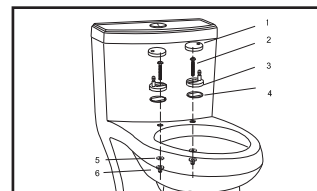

iii. Rotate the hinge so that the vertical posts are toward the sides of the bowl. Make sure that the vertical posts can be inserted into the holes on the seat cover.



iv. Adjust the seat cover to make sure it can match the rim of the toilet properly.

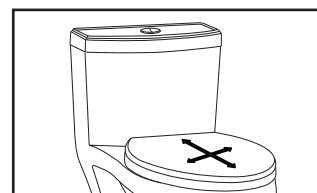

v. When the seat cover is in position, tighten the nuts. Don't over tighten.

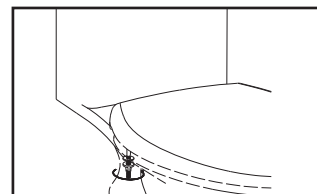

vi. If you need to remove the seat cover, press the two buttons on the seat and release, then lift the seat cover.



Trouble-Shooting

The trouble-shooting guide will assist should you encounter any difficulties with your new tank.

MAINTENANCE

Wipe the outside of the toilet with a non abrasive cleaner and a soft towel. Make sure the complete surface is clean and dry.

NOTE: IMPROPER CARE MAY VOID THE WARRANTY



Problem	Action
No water flow when flushed Water will not shut off	<p>Replace fill valve seal</p> <p>Ensure water is not flowing into the overflow tube, if so, lower water level by pinching the water level adjustment clip and lowering float cup on stainless steel link.</p> <p>Debris inside the head may be obstructing the seal. Remove cap, clean debris away and reassemble.</p> <p>Refill tube is inserted too far into overflow tube (below tank water level). Attach refill tube adaptor to top of flush valve overflow. Flow from the refill tube must be positioned directly over the overflow tube.</p>
Water dripping from cap during refill	This is normal for pilot type valves. This feature allows the pilot valve orifice to self clean during refill. The water may continue to drip for 10 or 15 seconds at the end of the refill cycle. It should stop when float rises to the full "off" position.
Water dripping from air ports during refill	This may indicate a very low water pressure condition. The dripping should stop when float rises to the "off" position.
Too little water in bowl	Ensure refill hose directed into overflow tube and the flow is not obstructed or restricted.

Replacement Parts

Keep this manual for ordering replacement parts.

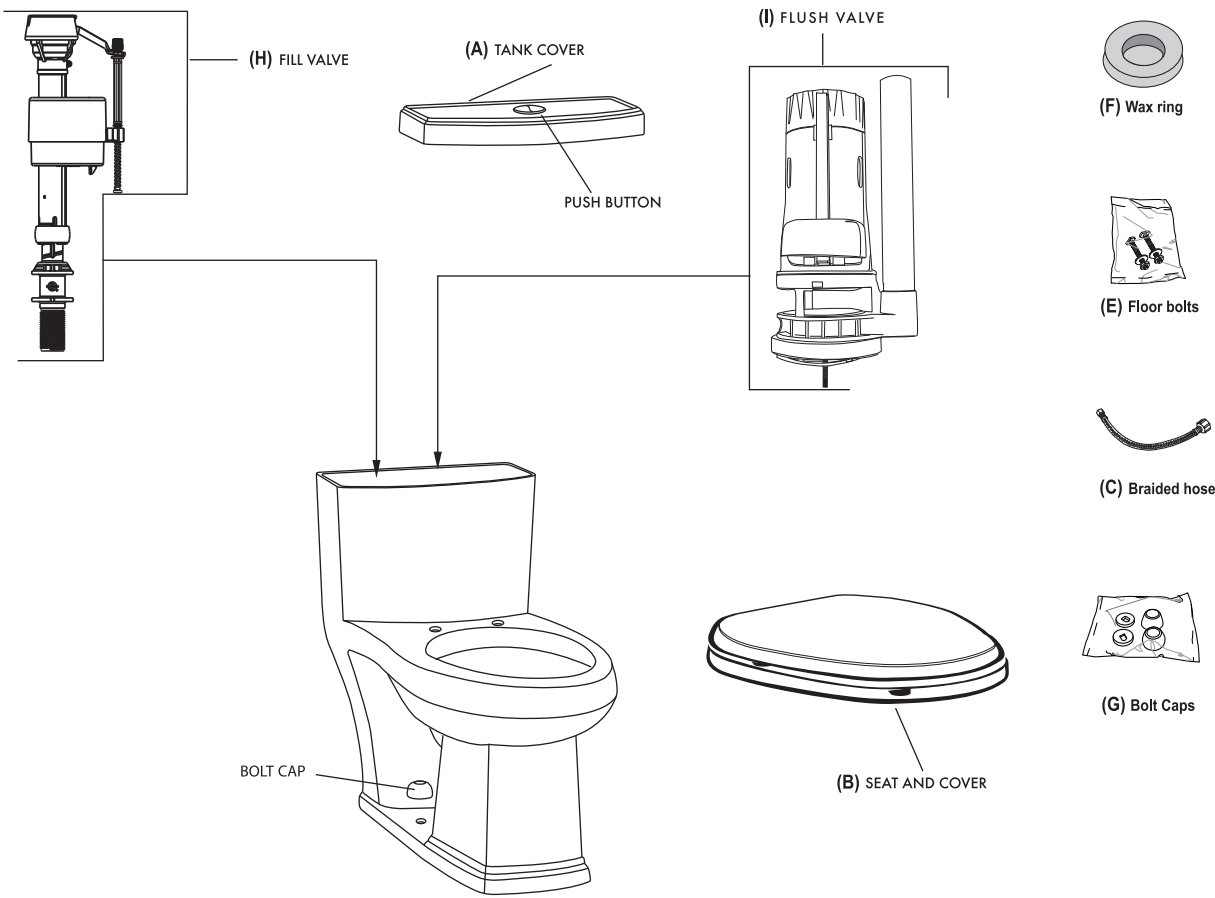

Need Help? Please call our toll-free Customer service line at **1-866-789-2273 (ENGLISH)** for additional assistance or service.
Call Monday through Friday 8am-8pm, Saturday 9am-6pm **(EASTERN TIME)**



WaterRidge Five Years Limited Warranty

All parts of the WaterRidge product are warranted to the original consumer purchaser to be free from defects in material and workmanship under reasonable use for a period of five years from the date of original purchase, as shown on the original consumer-purchaser's receipt

WaterRidge will replace" free of charge ", during the warranty period, any part that proves defective in material and/or workmanship under normal residential application. Avoid abrasive cleaners, steel wool and harsh chemicals. These will dull the finish and void your warranty.

THIS WARRANTY IS LIMITED TO REPLACEMENTS ONLY AND DOES NOT COVER OR INCLUDE LABOR CHARGES OR DAMAGE INCURRED IN INSTALLATION, REPAIR OR REPLACEMENT OR ANY INCIDENTAL OR CONSEQUENTIAL DAMAGES WHATSOEVER, NOR DOES IT COVER OR INCLUDE DAMAGES FOR PERSONAL INJURY, PROPERTY DAMAGE OR ECONOMIC LOSS.

Any damage to this product as a result of improper installation misuse, accident, neglect or any use that violates the instructions furnished by us, WILL VOID WARRANTY IMMEDIATELY. This warranty is only valid to the original consumer purchaser and excludes industrial, commercial use of the product.

Need Help?

Please call our toll-free Customer service line at **1-866-789-2273 (ENGLISH, EASTERN TIME)** for additional assistance or service.
Call Monday through Friday 8am-8pm, Saturday 9am-6pm.

